



Manor Park Road,  
London, NW10 4JW

Asking Price Of £395,000

# Property Summary

Magicbrick are pleased to present to the market this new build two-bedroom apartment situated in this popular residential area. The property comprises of an open plan lounge kitchen, two double bedrooms with a family bathroom and en-suite shower room. The property benefits from double glazing, gas central heating, communal ground, long lease and chain free.

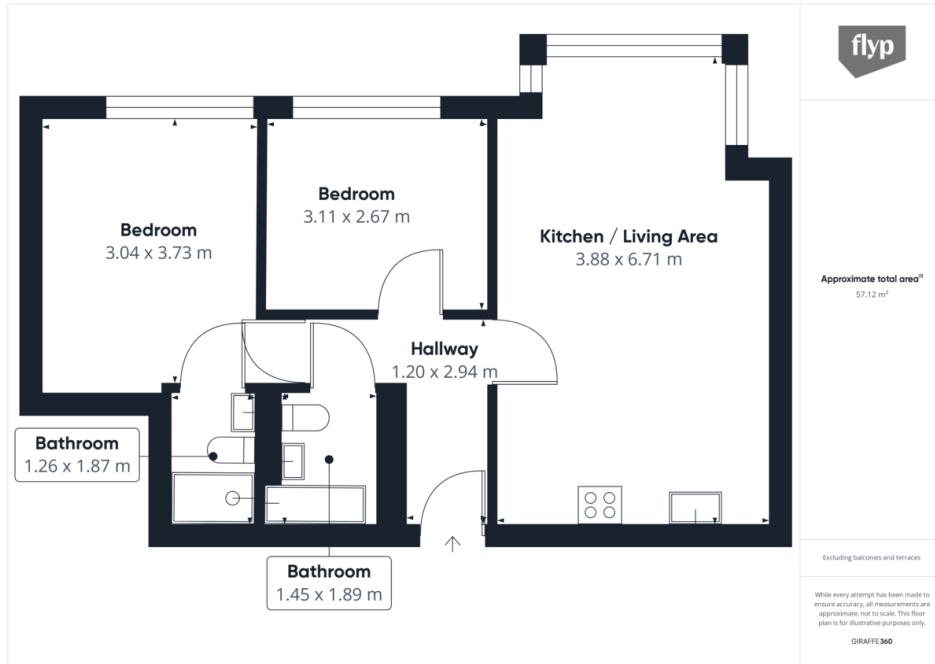

Score	Energy rating	Current	Potential
92+	A		
81-91	B	82 B	82 B
69-80	C		
55-68	D		
39-54	E		
21-38	F		
1-20	G		

- New Build Apartment
- Two Double Bedrooms
- Two Bathrooms
- Communal Gardens
- Long Lease
- Chain Free
- Double Glazed
- 10-Year New Build Warranty
- Modern Fitted Appliances
- Close To Transport Links

432 Alexandra Avenue  
Harrow  
Middlesex  
HA2 9TW

www.magicbrick.co.uk  
sales@magicbrick.co.uk  
0208 004 4225

Agents Note: Whilst every care has been taken to prepare these sales particulars, they are for guidance purposes only. All measurements are approximate and for general guidance purposes only and whilst every care has been taken to ensure their accuracy, they should not be relied upon and potential buyers are advised to recheck the measurements