

Windsor Close,
Northwood, HA6 1PE

£350,000

Property Summary

Magicbrick are pleased to present to the market this well maintained first floor maisonette which is situated close to local shops and transport links. The property comprises of a lounge, kitchen, two bedrooms and bathroom. The property benefits from double glazing, gas central heating, rear garden, and garage. Chain free



FIRST FLOOR
601 sq.ft. (55.8 sq.m.) approx.

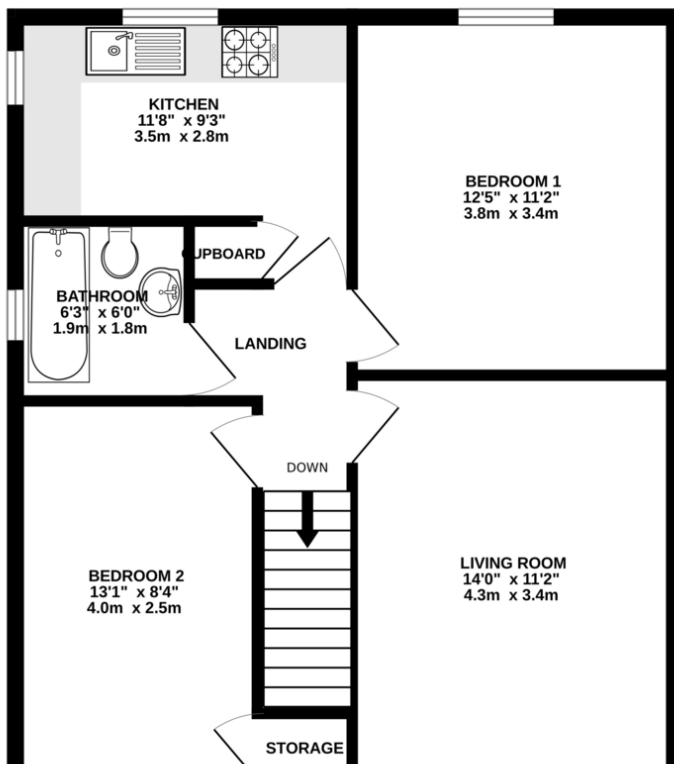

Score	Energy rating	Current	Potential
92+	A		
81-91	B		
69-80	C		77 C
55-68	D		
39-54	E	51 E	
21-38	F		
1-20	G		

- First Floor Maisonette
- Two Bedrooms
- Kitchen
- Garden
- Garage
- Chain free
- Close to transport links
- Easy access to schools and shops
- Long Lease

432 Alexandra Avenue
Harrow
Middlesex
HA2 9TW

www.magicbrick.co.uk
sales@magicbrick.co.uk
0208 004 4225

Agents Note: Whilst every care has been taken to prepare these sales particulars, they are for guidance purposes only. All measurements are approximate and for general guidance purposes only and whilst every care has been taken to ensure their accuracy, they should not be relied upon and potential buyers are advised to recheck the measurements